

Section 39 Corner Lot Restrictions

39.1 Notwithstanding any other provision in this Bylaw, no person shall erect or maintain any object, structure, fence, wall, tree, hedge, shrub or other structure exceeding 1.0m in height in a corner visibility triangle.

39.2 Corner visibility triangles are determined as follows:

(Bylaw C-1260-79 - February 25, 2019)

- a. A sight triangle is comprised of two (2) sides which are 6.0m long, as measured from the corner of the corner lot along the boundaries of the lot which meet at the said intersection, and a third side the length of which is a straight line connecting the two (2) points along the said boundaries; or,
 - b. If the corner lot is at the intersection of a lane and a street in a Residential District, or if a corner lot is located in a commercial or industrial district, a visibility triangle is comprised of two (2) sides which are 3.0m long, as measured from the corner of the corner lot along the boundaries of the lot which meet at the said intersection, and a third side the length of which is a straight line connecting the two (2) points along the said boundaries.
- 39.3 Unless otherwise permitted in this Bylaw, the minimum setbacks on a Corner Lot shall be as follows:

- a. A 4.6m Side Yard setback;
- b. A 6.0m Front Yard setback; and
- c. The minimum Side Yard setback may be reduced by increasing the Front Yard setback at a rate of 0.15m less Side Yard for every 0.3m of added Front Yard setback down to a minimum 1.5m Side Yard Setback.

(Bylaw C-1260-123 - August 24, 2020)

39.4 Unless otherwise permitted in this Bylaw, the minimum Side Yard setback for an Inside Corner Lot in any Residential District shall be 1.5m.

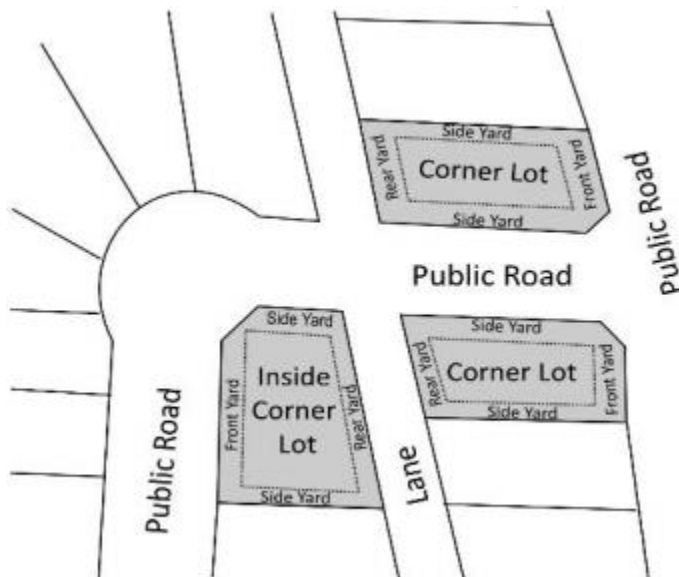

(Bylaw C-1260-123 - August 24, 2020)